

POOLS/SPAS/WATER FEATURES/SCREEN ENCLOSURES/ PLAY EQUIPMENT

All water features are required to be located in rear yards. All water features shall be in-ground, except spas, which may be built into appropriately designed and screened deck systems. Equipment for pools, spas, or fountains should be completely screened from adjoining properties and front and rear views. Small temporary play children's pools are allowed. Safety fencing to be provided in accordance with community fencing guidelines and local codes. Any proposed swimming pool screen cages shall be designed and included as part of the architectural review process.

Permanent play equipment will be placed within the building setback lines and landscaped to help minimize the visual impact on adjacent property owners and from public streets. Basketball hoops shall be portable and be stored out of sight when not in use.

APPROPRIATE

- In-ground pools with approved fencing and screening.
- In-ground or in-deck spas with approved fencing and screening.
- Screened enclosures within setbacks.
- Fountains to be located in rear yards only unless provided by Developer as a community feature.

NOT ALLOWED

- Permanent above ground pools.
- Above ground spas (unless built into a deck system with spa flush to top of deck or part of an inground pool/spa combination).
- Permanent basketball hoops in the front yard.
- Permanent playground equipment outside of building setbacks.

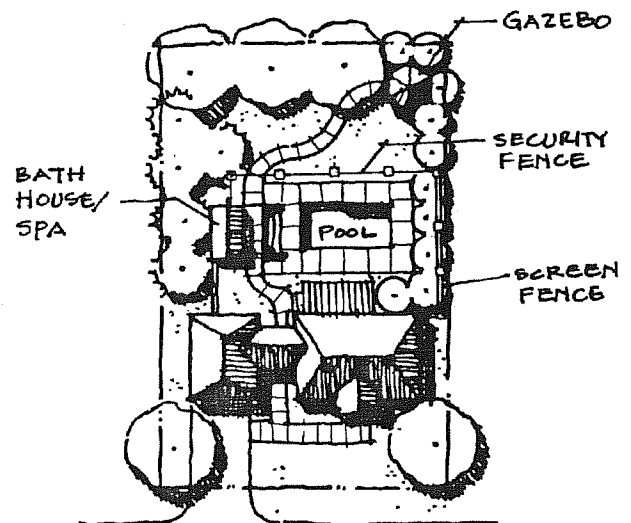

Typical Pool/Spa Arrangement

**POOLS/SPAS/WATER
FEATURES/SCREEN
ENCLOSURES/
PLAY EQUIPMENT (CONTINUED)**

NOT ALLOWED

- No white pool enclosures or screening structures.
- Height of screen structures can be no higher than roof of the house.
- No screen may project over the existing roof planes.